

SCB4



Super Ball Bushing Bearing

SUPER, Ball Bushing Bearing Cartridge Bearing, 0.250, Self-Aligning, Closed Type, Non-Adjustable, Not Corrosion Resistant

Lead Time: Next Day

\$40.66 each[†]

- The Super Ball Bushing bearing is self-aligning, lightweight and adjustable with a low coefficient of friction.
- The wear-resistant, engineered-polymer retainers and outer sleeves reduce inertia and noise in critical, high speed applications.
- Radially floating bearing plates. When installed in an adjustable housing, the Super Ball Bushing Bearing may be adjusted to a specific diametrical fit-up for accurate and repeatable movement.

[†]The price shown here is the North American List Price for general reference only. Please Contact Thomson for actual net price and current delivery schedule which will vary with geographic region, quantity ordered and distribution channel. Estimated costs for shipping, packaging and import taxes/duty are not included in this list price. Please contact Thomson Customer Support for more information.

Dimensions

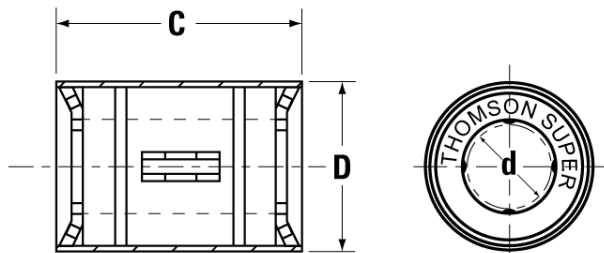

| Dimension | Value |
|-----------|---------------------|
| C | 25.40 mm (1.000 in) |
| d | 6.35 mm (0.250 in) |
| D | 13.49 mm (0.531 in) |

Specifications

| Specifications | Value |
|---------------------------|----------------|
| Adjustable/Not Adjustable | Not Adjustable |
| Closed/Open | Closed |
| Number of Ball Circuits | 4 |
| Roll Pack | No Roll Pack |
| Food Grade Rated | Not Food Grade |
| Self Alignment | Self-aligning |

| Specifications | Value |
|-------------------------|----------------------|
| Single/Twin | Single |
| Temperature Max | 85 °C / 185 °F |
| Use with shafting class | L |
| Wipers, Seals | |
| Weight | 0.005 kg / 0.01 lbs |
| Nominal Diameter | 6.350 mm / 0.25 in |
| Outer Diameter | 13.487 mm / 0.531 in |
| Length | 25.400 mm / 1 in |

Performance

Load Correction Factor, K_{θ}

| Performance | Value |
|------------------------|--------------------|
| Load Capacity, Dynamic | 266.893 N / 60 lbf |

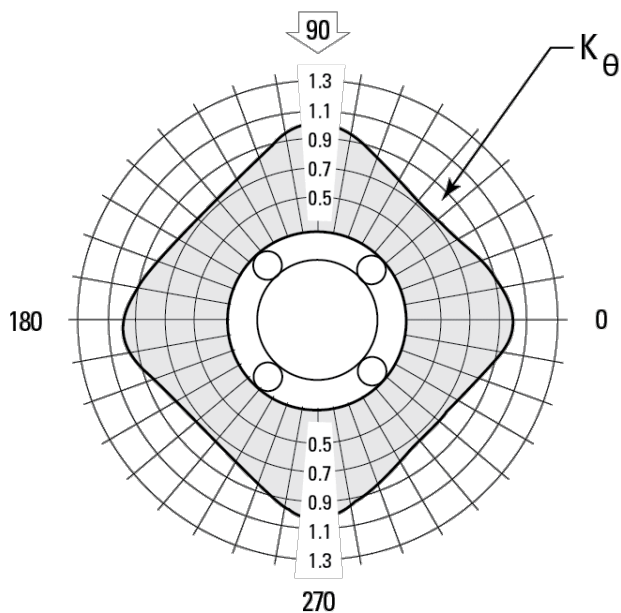

The actual dynamic load capacity of a Ball Bushing Bearing is determined by the direction of the applied load relative to the bearing circuits. The load correction factor K is found by referring to the polar graph. To determine the actual dynamic load capacity, multiply the proper correction factor (K) by the dynamic load capacity.

Travel Life

The following formula may be used to determine travel life for bearings with imperial units:

$$L_m = \left(\frac{W}{P} \cdot K_\theta \cdot K_s \right)^3 \cdot 2 \cdot 10^6 \text{ inches}$$

Where: L_m = travel life (in)
 W = dynamic load capacity rating (lbf)
 P = resultant from externally applied loads (lbf)
 K_θ = load correction factor
 K_s = shaft hardness factor

Shaft Hardness factor, K_s

For shafts that do not meet hardness 60 HRC, shaft hardness factor K_s must be applied.

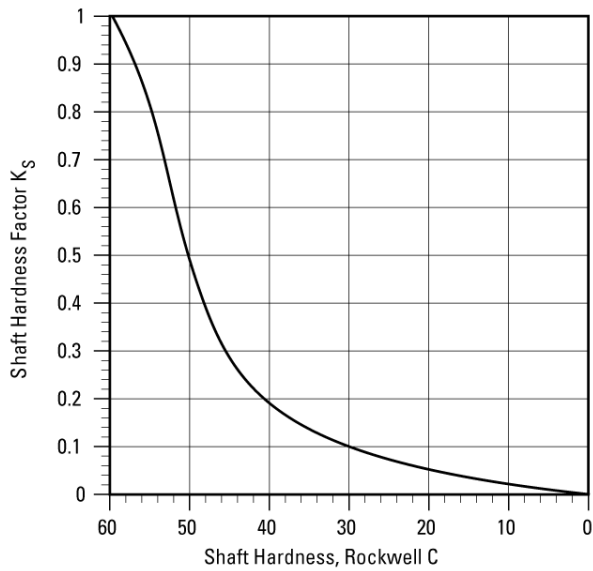

Order Code

SUPER16DD-CR

| Type | Description | Size | Nominal Diameter | Seals Options | Ball Options | Lube Options | Other Options |
|------|------------------------------------------|------|------------------|-------------------|-----------------------------|-------------------------------------------|-----------------------|
| SCB | Super Ball Bushing Cartridge bearings | 3 | .188 | Blank No Seals | Option Description | DP Dry Pack | RP Roll Pack (no box) |
| | | 4 | .250 | DD Integral Seals | CR Corrosion Resistant | LL Lubricated with Thomson Linear Lube | |
| | | 6 | .375 | | NB Nylon Balls | | |
| | | 8 | .500 | | NBA Alternating Nylon Balls | | |
| | | 10 | .625 | | | | |
| | | 12 | .750 | | | | |
| | | 16 | 1.000 | | | | |
| | | 20 | 1.250 | | | | |
| | | 24 | 1.500 | | | | |
| | | 32 | 2.000 | | | | |

Related Products



1/4 L CTL

1/4" Shafting, L Class, Cut to Length

<https://www.thomsonlinear.com/en/product/1/4 L CTL>